



# PAC BOSS 66

## Hydrophilic Construction Joint Waterstop

### DESCRIPTION

**PAC Boss 66** is a flexible hydrophilic natural rubber and bentonite waterstop for sealing construction joints and precast elements that expands on contact with water. It is manufactured from sustainable materials, bentonite & natural rubber that do not negatively impact the environment.

### TYPICAL USES

**PAC Boss 66** is used to stop water infiltration through both vertical and horizontal non moving construction joints, irregular surfaces and around penetrations through concrete. It is not intended as an expansion joint sealant. It is designed to replace conventional waterstop in construction joints. The Sodium Bentonite in **PAC Boss 66** is the catalyst to its success. Bentonite swells when in contact with water, blocking pores, capillaries, minor cracks & other paths for water, forming a permanent impermeable barrier. Uses include in construction joints in various structures including tunnels, basements, culverts, underground structures, pools, reservoirs, canals etc.

### ADVANTAGES

- Light weight flexible coils, easy to install.
- Eliminates seam welding & split forming associated with PVC waterstop.
- Butt end joining, gives a continuous waterstop length.
- Withstands hydrostatic water head up to 70 meters.
- Forms a positive seal, sealing cracks & small voids.
- May be used in potable water tanks. **PAC Boss 66** is non toxic.
- Can apply to irregular concrete surfaces, No need to level surfaces out.
- Unaffected by repeated wetting & drying cycles.
- Does not deteriorate, lasts life of structure.
- Fast installation.
- Self healing. (Can take punctures by nails, screws, fasteners and expand to encapsulate these penetrations).

### TECHNICAL DATA

Typical Properties

Hydrostatic Head Resistance	: > 70 m
S.G. (ASTM D297)	: 1.5-1.6
Wet / Dry Cycling	: No effect
Service Temperatures	: -40C to 80C

Elongation	: >300%
Color	: Black
Penetration Cone	: 4±5 (ASTM D-217)
Expansion (by volume)	: >180% (7 days)

\*Note: expansion is related to the quality of water and its temperatures. Do not use in expansion joints.

### Installation of PAC Boss 66

#### Surface Preparation

The surface should be clean and dry with all dirt, aggregate, rust, debris or standing water removed.

#### General Installation Instructions

Apply **PAC Boss 66** adhesive by brush along the concrete by the width of the **PAC Boss 66** roll. One liter of adhesive will cover approximately 30 meters. Whilst still tacky (within 10-15 minutes) apply the **PAC Boss 66**. Remove the release paper and press the Boss 66 firmly to the surface for several seconds. At the highest coil end on vertical sections pay particular attention. If the adhesive has dried out reapply to the surface. Mechanical fasteners may be used with Boss 66 and in conjunction with adhesive. Tightly butt ends together to form a continuous waterstop. Do not pre-hydrate or submerge in water.

### DRAWING DETAILS

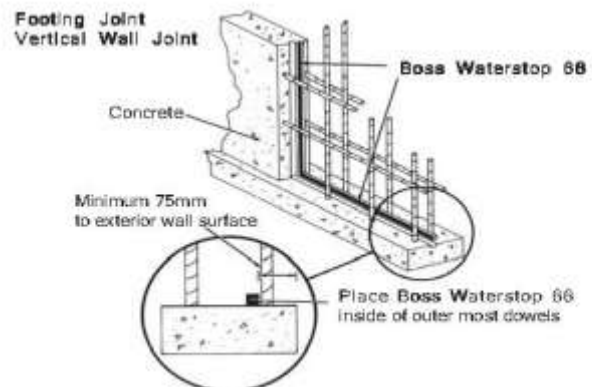

Typical Placement of **PAC Boss 66** at concrete construction joints

**Penetrations:** For penetrations follow the general installation procedures.

**Single Pipe:** Install around outer diameter of the pipe.

**Multiple pipes:** Install around each pipe as well as around block out box construction



**Sleeved Pipes:** Install around the outer diameter of the sleeve. Install another strip between sleeve's inner diameter & the pipe; if there is an excessive gap between inner diameter of the sleeve & the pipe, then 2 separate waterstop may be required; installing one on the inner diameter & the other on the pipe. The void should be filled with non shrink cementitious grout.

**Sizes available and packaging**

- 25 x 19 mm. x 5.0 Lineal Metres per roll  
There are 6 rolls per carton.
- 20 x 20 mm. x 4.6 Lineal Metres per roll  
There are 6 rolls per carton.
- 20 x 15 mm. x 6.0 Lineal Metres per roll  
There are 6 rolls per carton.
- 20 x 10 mm. x 9.0 Lineal Metres per roll  
There are 6 rolls per carton.
- 20 x 5 mm. x 13.0 Lineal Metres per roll  
There are 6 rolls per carton.

**Primer / Adhesive:** 5 liter plastic pails  
1 liter per 25-35 LM of standard profile 19x25mm

**Limitations**

**PAC Boss 66** should be used in areas fully confined in concrete by a minimum of 75 mm cover. To achieve success the installation instructions should be followed. Any hydrated material should be allowed to dry before placement of concrete

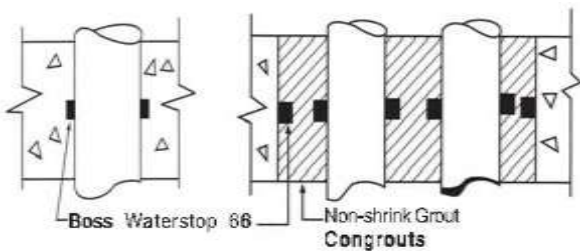

**Single & Multiple pipe penetration**

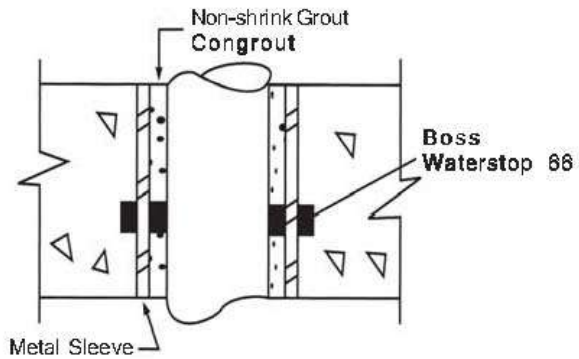

Placement of PAC Boss 66 at typical construction joints

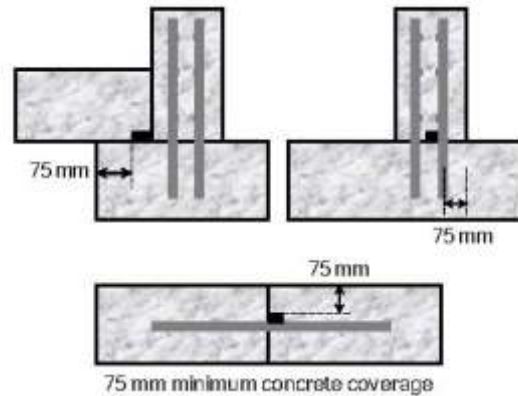

**STORAGE & SHELF LIFE**

Store in dry environment in original boxes undercover, protected from direct sunlight and rain. The shelf life is at least 12 months.

**HEALTH & SAFETY**

There are no known hazards associated with PAC Boss 66 during normal use. Refer to product material safety data sheet.



P.O. Box no 282 676 Dubai-UAE  
Tel: +971 4 885 0 886  
Fax: +971 4 885 0 887  
Visit us: [www.pactechnologies.ae](http://www.pactechnologies.ae)

Important Note: Whilst any information contained herein is true, accurate and represents our best knowledge and experience, no warranty is given or implied with any recommendations made by us, as the conditions of any labor involved in the application is beyond our control. PAC Technologies shall not be liable for any injury, loss or damage, direct or consequential, arising out of the use of this product. It is the responsibility of the user to ensure that the product meets his particular requirements and to use it in a suitable way. Field service, where provided, does not constitute supervisory responsibility. For additional information contact your local PAC Technologies representative.